

Using DuckDuckGo

Donate

[Home](#) [How Tails works](#) [Get Tails](#) [Documentation](#) [Support](#) [Contribute](#) [News](#)[doc](#)[anonymous internet](#)[Connecting to a local network](#)[English](#) [DE](#) [ES](#) [FR](#) [IT](#) [PT](#) [RU](#)

Connecting to a local network

- I. [Connecting to a local network](#)
- II. [Saving your network settings](#)
- III. [Modifying your network settings](#)

Connecting to a local network

You can connect to a local network using a wired, Wi-Fi, or mobile data connection:

1. Open the system menu in the top-right corner.

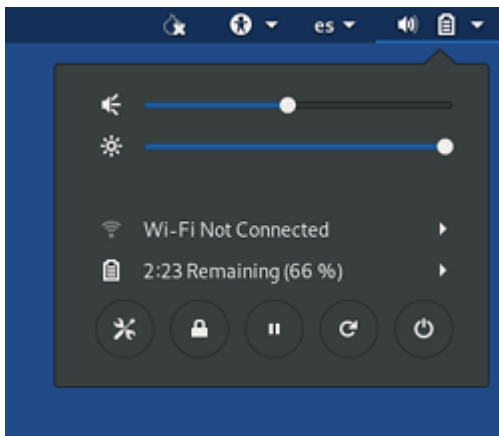

- If a wired connection is detected, Tails automatically connects to the network.
- To connect to a Wi-Fi network, choose **Wi-Fi Not Connected** and then **Select Network**.

If there is no option to connect to a Wi-Fi network, your Wi-Fi interface is not working in Tails. See our documentation on [troubleshooting Wi-Fi not working](#).

- To connect to a mobile data network, choose **Mobile Broadband**.

It is currently impossible to connect to a network using:

- Dial-up modems.
- VPNs, see [the corresponding FAQ](#).

2. After you connect to a local network, the *Tor Connection* assistant appears to help you [connect to the Tor network](#).

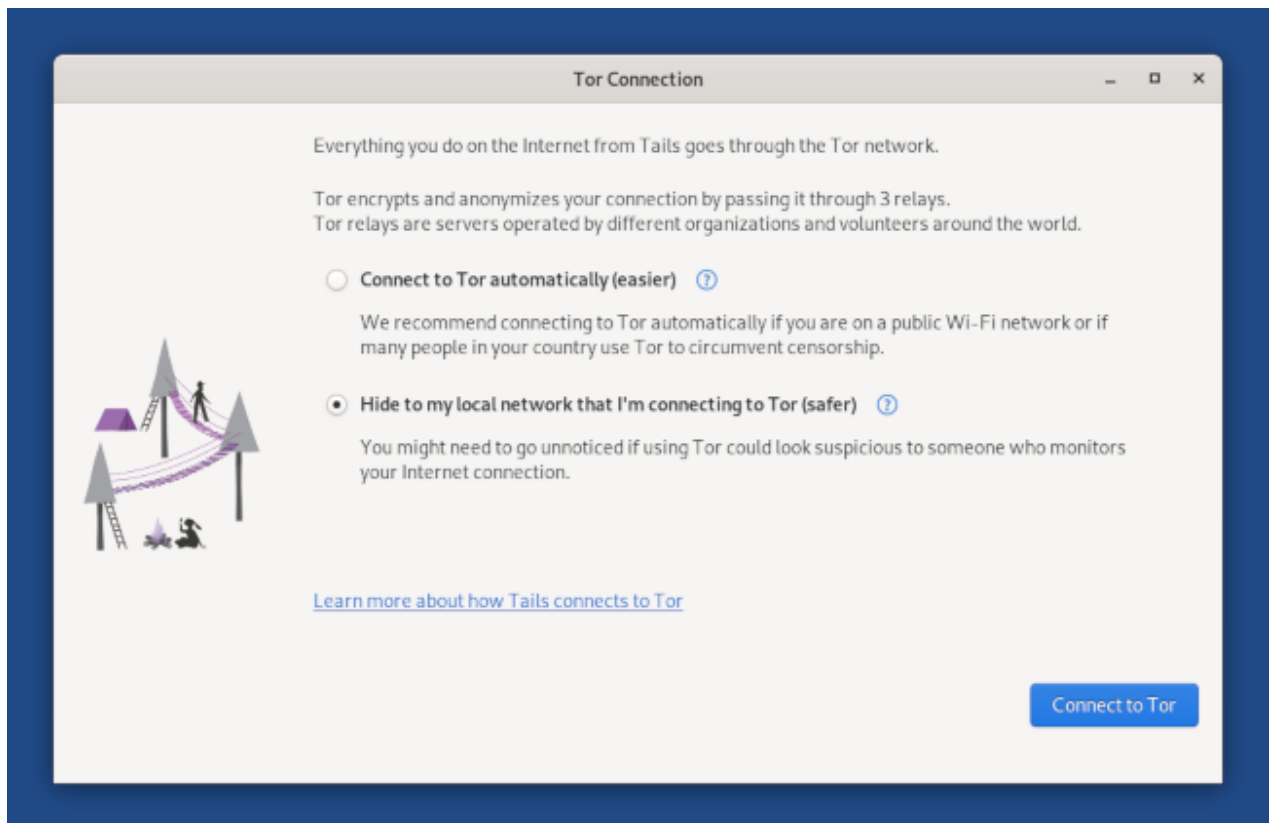

For more information, open [GNOME Help](#) and choose **Networking, web & email**.

Saving your network settings

To remember the password for Wi-Fi networks and custom network configurations across different Tails sessions, turn on the [Network Connections](#) feature of the Persistent Storage.

Modifying your network settings

To modify your network settings, for example, to configure whether or not to automatically connect to a Wi-Fi network, choose **Applications ▶ System Tools ▶ Settings ▶ Network**.

Tails

- [Home](#)
- [How Tails works](#)
- [Get Tails](#)
- [Documentation](#)
- [Support](#)
- [Contribute](#)
- [News](#)

Support

- [FAQs](#)
- [Known issues](#)
- [Warnings](#)
- [Accessibility](#)
- [Upgrade](#)

Contribute

- [Report an error](#)
- [Translate](#)
- [Source code](#)
- [GitLab](#)
- [Roadmap](#)
- [Donate](#)

About us

- [Contact](#)
- [Mission and values](#)
- [Social contract](#)
- [Sponsors](#)
- [Code of conduct](#)
- [License](#)
- [Jobs](#)

News

Subscribe to our newsletter:

